



325 Guthrie Drive
Benton, Kentucky 42055
www.malcolmcreek.com

*A Family & Sportsman's Resort
On Beautiful Kentucky Lake*



For Reservations
Phone (270) 354-6496
1-800-733-6713
www.malcolmcreek.com

Malcolm Creek Resort is located on the shore of Kentucky Lake approximately seven miles south of Kentucky Dam. From I-24, exit 25A to the Purchase Parkway to Exit 47, turn left on Highway 68 to Big Bear Highway. Malcolm Creek Resort is 3 miles on the left.

FACILITIES

COTTAGES

1. Central heat / air
2. Color cable TV w/ DVD Player
3. All are completely furnished: linens, dishes, pots and pans, microwaves, coffee makers and toaster.
4. Grills and picnic tables
5. All are two bedroom, one bath with a sofa bed in the living room.

LAUNDRY MAT

Coin operated washer, dryer and detergents are available for your convenience.

MARINA

1. We have boat slips open and covered.
2. Bait and tackle, license, snacks, gas and oil sales, t-shirts & souvenirs.
3. We have pontoon and fishing boat rentals.
4. Paddle boats for the energetic folks.
5. We also have water skis, tubes and tow ropes for rent.

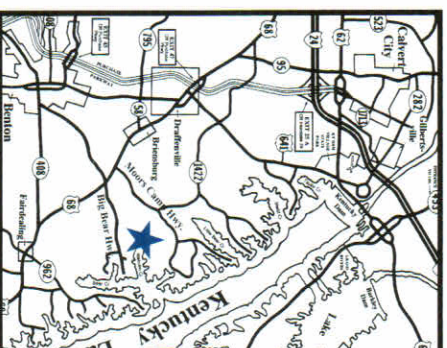

Malcolm Creek Bay is an excellent area for fishing, water skiing and other water sports.

Fishing guide service is available!



Free Wireless Internet

RECREATION FACILITIES

1. Swimming pool
2. Excellent bay for water skiing / tubing
3. Large playground
4. Several golf courses nearby
5. Paddle boats
6. Land Between the Lakes is a short drive.
7. Several fine restaurants only a short drive.
8. Fishing is excellent in our bay. We harbor the largest bass on Kentucky Lake in our embayment; he does leave from time to time, but always returns. Bass in the 4 to 6 pound range are caught from our shores. Bass, bluegill and catfishing is excellent from the dock. Crap-pie fishing is at its best in the winter, spring and fall, fair to good in the summer. Bass and catfishing are good year-round.



Toll Free: 800-733-6713 or 270-354-6496
www.malcolmcreek.com
 Contact: mcrm@mindspring.com

***COTTAGE RATES**

Persons	1 to 4	5	6
Cottages (Daily)	\$120	\$135	\$150
Weekly Rate (7 days)	\$700	\$800	\$900

Seniors (65 and over) & Military. 50% discount.
 Children under 5 years are FREE.

Cottage reservations require \$100.00 deposit.
 Office located at the dock, open 8 a.m. - 7 p.m.

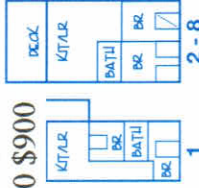

NO PETS IN COTTAGES

Check in 3:00 p.m.
 Check out 10:00 a.m.
 RATES DO NOT INCLUDE STATE & LOCAL TAX.

CANCELLATION POLICY

More than 30 days from reserved dates
 Deposit less 10% refunded
 Less than 30 days from reserved dates - NO REFUND

***MARINA RATES**

	Per Hr.	1/2 Day	Full Day	Wkly.
Paddle Boat	\$3			
Fishing Boats		\$30	\$50	\$200
Pontoons	\$50	\$150	\$195	\$1000
Boat Slip (per day)	Open	Covered		
	\$10	\$15		
Overnight Pontoon			\$300	\$1500

1. Half day rates 8 a.m. to 12 p.m. and 1 p.m. to 5 p.m.
2. Daily rates from 8 a.m. to 5 p.m.
3. Rates do not include gas, oil or state and local taxes.
4. Fishing boats sunrise to sunset.

*Prices subject to change.

